

Type and use :
Cylindrical unit under graded or tiered seating.

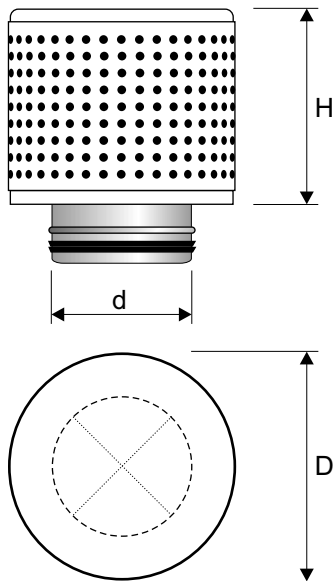

Dimensions and weight

GSO	H	D	d	Kg
08	130	160	80	0,6

Description, colours etc.

Made in 0.9 mm galvanised sheet steel.
Powder coated external finish.
Air spreader in galvanised sheet steel.
Cleanable and does not contain filter material.
Standard colour: White

Environmental declaration:

Standard packing in a cardboard carton on a wooden pallet.
Transportation by lorry.
All components can be recycled.
The company environmental policy can be obtained on Request.

Maintenance

Clean with water and a mild detergent solution.

Assembly

A circular hole should be made in the floor. The lower part of the unit is pushed in to the hole and fixed to the floor with screws. The circular top is pushed on to the bottom part and fixed with screws at the side.

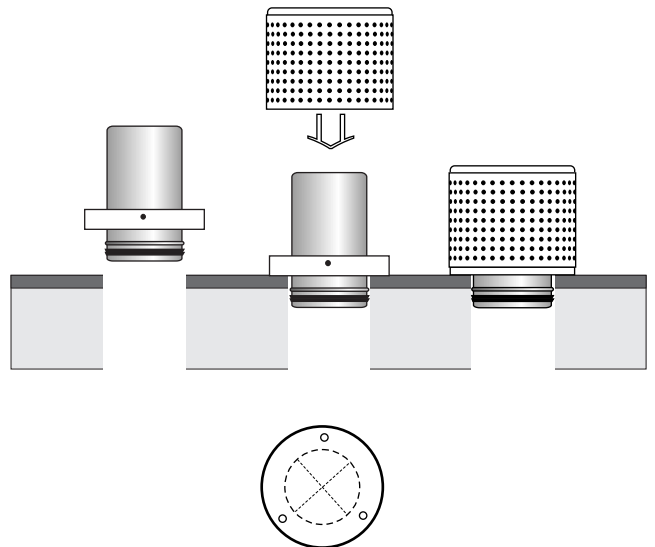

We recommend that the unit is fitted when all other building work is finished.

Adjustment, cleaning

Airflow adjustment to be carried out with an external damper.(Not incl.)
The unit and ductwork can be cleaned internally by removing the unit front panel.

Selection charts

L_{015} = Distance from the unit at a height of 100mm above floor level where the air velocity has reduced to 0,15 m/s, when the difference between supply air temperature and room temperature at 1,0 m above floor level equals 3° C.

ΔL = Sound attenuation (dB) / frequency, Hz. K_{ok} = Sound power level (dB) / frequency, Hz.

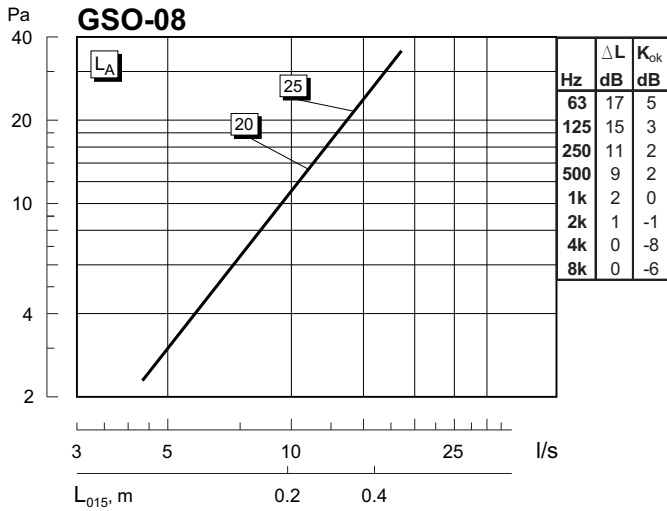

Installation alternatives

